



# FUN IN THE SUN

Starts With A Clean Pool



# Aastha Water Care

We are Manufacturer & Service Provider of Swimming Pool Cleaning Equipment, Water Softener and Swimming Pool Maintenance .

**Since 2020 in Gujarat**

In their development process, we assure that only top notch basic material is used by our professionals along with ultra-modern tools and machinery. Besides this, we check these on a variety of grounds before finally shipping them at the destination of our customers



# Swimming Pool Bobbin Wound Sand Filter



## Top Mount Valve Filter

### Features

- TOP MOUNT Sand Filters are manufactured with high grade fiberglass and resins utilizing the latest engineering techniques ensuring high quality and superior strength for long life and durability. Just as sand is utilized to clean our oceans and rivers you can enjoy the benefits of a sand filtered swimming pool.
- High Rate Sand Filters- the natural solution for perfectly filtered pool water.
- Heavy duty UV resistant fiberglass tank.
- Ergonomically designed six position multiport valves.
- High performance filtering action.
- Resistant to chemicals and corrosion.
- Sight glass for inspection of filtered water.
- Pressure gauge for inspection of operating pressure.
- Virtually maintenance free, simply backwash filters when required.
- Sand drain plug for easier sand removal/replacement.
- The Outlet Turbidity is Less than 2 NTU

### Specifications

**Maximum Working Pressure :** 2.5 kg/cm<sup>2</sup> (35psi)

**Testing Pressure :** 4 kg/cm<sup>2</sup>

**Maximum Water Temperature :** 50° C

Model	Design Flow m <sup>3</sup> /h	Filtration Area	Pipe Size	Sand Required kg
T400-16"	6.7	0.13	1.5	50
T450-18"	8.2	0.17	1.5	75
T500-21"	10.8	0.22	1.5	90
T550-22"	12.5	0.25	1.5	110
T650-25"	16.4	0.36	1.5	170
T700-28"	21.3	0.41	1.5	190
T750-30"	24.2	0.45	2.0	210
T800-33"	26.8	0.51	2.0	300
T900-36"	32.6	0.65	2.0	400
T1000-40"	40.3	0.81	2.0	500
T1100-44"	49.0	0.99	2.0	600
T1200-48"	56.0	1.14	2.0	750
T1400-56"	76.3	1.56	2.0	1000



# Swimming Pool Bobbin Wound Sand Filter



## Side Mount Valve Filter

### Features

- Side Mount Sand Filters are manufactured with high grade fiberglass and resins utilizing the latest engineering techniques ensuring high quality and superior strength for long life and durability. Just as sand is utilized to clean our oceans and rivers you can enjoy the benefits of a sand filtered swimming pool.
- High Rate Sand Filters- the natural solution for perfectly filtered pool water.
- Heavy duty UV resistant fiberglass tank.
- Ergonomically designed six position multiport valves.
- High performance filtering action.
- Resistant to chemicals and corrosion.
- Sight glass for inspection of filtered water.
- Pressure gauge for inspection of operating pressure.
- Virtually maintenance free, simply backwash filters when required.
- Sand drain plug for easier sand removal/replacement.
- The Outlet Turbidity is Less than 2 NTU

### Specifications

**Maximum Working Pressure :** 2.5 kg/cm<sup>2</sup> (35psi)

**Testing Pressure :** 4 kg/cm<sup>2</sup>

**Maximum Water Temperature :** 50° C

Model	Design Flow m <sup>3</sup> /h	Filtration Area	Pipe Size	Sand Required kg
S400-16"	6.420	0.13	1.5	70
S450-18"	7.920	0.16	1.5	80
S500-21"	9.900	0.20	1.5	100
S550-22"	11.88	0.24	1.5	130
S650-25"	16.34	0.33	1.5	170
S700-28"	20.30	0.41	1.5	190
S750-30"	21.78	0.44	2.0	210
S800-33"	24.75	0.50	2.0	300
S900-36"	31.68	0.64	2.0	400
S1000-40"	39.10	0.79	2.0	500
S1100-44"	47.03	0.95	2.0	600000
S1200-48"	55.94	1.13	2.0	750
S1400-56"	76.23	1.54	2.0	1000



# Swimming Pool Bobbin Wound Sand Filter



## Commercial Filter

### Features

- Commercial Sand Filters are manufactured with high grade fiberglass and resins utilizing the latest engineering techniques ensuring high quality and superior strength for long life and durability. Just as sand is utilized to clean our oceans and rivers you can enjoy the benefits of a sand filtered swimming pool.
- It is the best choice that is applied to public pools, water amusement parks, aquariums and other water treatment facilities.
- High Rate Sand Filters- the natural solution for perfectly filtered pool water.
- Heavy duty UV resistant fiberglass tank.
- Ergonomically designed six position multiport valves.
- High performance filtering action.
- Resistant to chemicals and corrosion.
- A Unique and advanced design ensures fast draining and stabilizes water flow.
- Pressure gauge for inspection of operating pressure.
- Virtually maintenance free, simply backwash filters when required.
- Sand drain plug for easier sand removal/replacement.
- The Outlet Turbidity is Less than 2 NTU

### Specifications

**Maximum Working Pressure :** 4.0 kg/cm<sup>2</sup> (58 psi)

**Testing Pressure :** 6 kg/cm<sup>2</sup>

**Maximum Water Temperature :** 50° C

Model	Design Flow m <sup>3</sup> /h	Filtration Area m <sup>2</sup>	Pipe Size Inch	Sand Required (kg)
SF-1200	56	1.14	3	1100
SF-1400	76	1.56	4	1900
SF-1600	100	2.01	4	2600
SF-1800	129	2.54	4	3500
SF-2000	157	3.14	6	4100
SF-2400	218	4.34	6	8900
SF-2500	246	4.91	6	11000



# Swimming Pool High Flow Circulation Pumps

## Swimming Pool Pumps Manufacturer



Overall Dimensions:

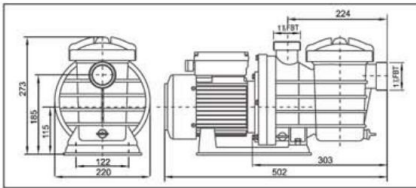

Performance Curve:

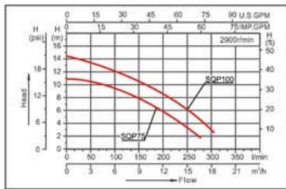

SQP Series

**Model No: SQP75, SQP100**

**Application :**

SQP Series pumps are used in swimming pool, spas, Jacuzzi, bhtubs and cleaning systems.

**Features:**

- Self Priming
- Wet ends made of high reinforced engineering thermal plastic with compact structure and corrosive resistance.
- 1.5 inch inlet and outlet
- High efficient structure design for diffuser and impeller to get high performance.
- Compact Design
- Maximum Suction 1.5mtr.

**Motor:**

- 2 Pole induction motor single phase 220-240V/50Hz single phase with thermal protector
- F Class insulation
- IP55 Protection Class
- Built with Thermal Protector

Model	Power KW / HP	Max head m	Max flow L / min	Fitting size mm	Dimension mm	Weight (kg)
SQP75	0.55/0.75	11	280	48.5 or 50	535*250*330	10.6
SQP100	0.75 / 1.0	14.5	310	48.5 or 50	535*250*330	11



Overall Dimensions:

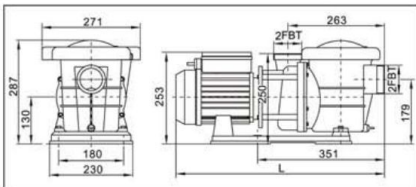

Performance Curve:

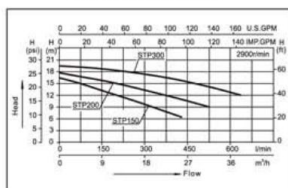

STP Series

**Model No: STP 150, STP 200, STP 300**

**Application :**

STP Series pumps are used in swimming pool, spas, Jacuzzi, bhtubs and cleaning systems.

**Features:**

- Wet ends made of high reinforced engineering thermal plastic with compact structure and corrosive resistance.
- 2 inch inlet and outlet
- High efficient structure design for diffuser and impeller to get high performance.
- Compact Design
- Maximum Suction 1.5mtr.

**Motor:**

- 2 Pole induction motor single phase 220-240V/50Hz single phase with thermal protector
- F Class insulation
- IP55 Protection Class
- Built with Thermal Protector

Model	Power KW / HP	Max head m	Max flow L / min	Fitting size mm	Dimension mm	Weight (kg)
STP150	1.10/1.50	16.5	430	48.5/50/60.3/63	600x280x345	14
STP200	1.50/2.00	18	310	48.5/50/60.3/63	600x280x345	15.5
STP300	2.3/3.0	19	340	48.5/50/60.3/63	600x280x345	18



# Swimming Pool High Flow Circulation Pumps

## Swimming Pool Pumps Manufacturer



SWIM-2 Series

**Model No:** SWIM 2-150, SWIM 2-200, SWIM 2-250, SWIM 2-300, SWIM 2-400

**Application :**

SWIM 2 Series pumps are used in swimming pool, spas, Jacuzzi, bhtubs and cleaning systems.

**Features:**

- Self Priming
- Wet ends made of high reinforced engineering thermal plastic with compact structure and corrosive resistance.
- 2 inch inlet and outlet
- High efficient structure design for diffuser and impeller to get high performance.
- Complant Design
- Maximum Suction 3.0mtr.

**Motor:**

- 2 Pole induction motor single phase 220-240V/50Hz single phase with thermal protector
- F Class insulation
- IP55 Protection Class
- Built with Thermal Protector

Overall Dimensions:

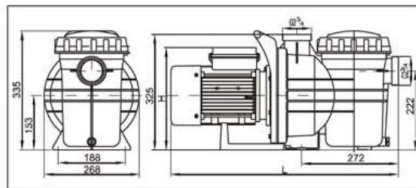

Performance Curve:

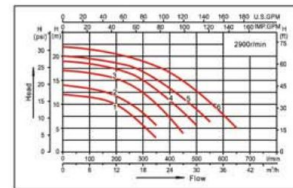

Model	Power KW / HP	Max head m	Max flow L / min	Fitting size mm	Dimension mm	Weight (kg)
SWIM 2-150	1.1/1.5	14	350	48.5 or 50	640x290x385	8.9
SWIM 2-200	1.5/2.0	17	450	48.5 or 50	640x290x385	9.5
SWIM 2-250	1.85/2.5	19	500	48.5 or 50	640x290x385	10.5
SWIM 2-300	2.2 / 3.0	20	550	48.5/50/60.3.63	640x290x385	14
SWIM 2-400	3.0/4.0	22	650	48.5/50/60.3.63	640x290x385	15.5



# Swimming Pool Basin Items

## Main Drain

We also have with us extensive experience in successfully matching up with the demands of Square ABS Main Drain. These are highly instrumental in matching up with the specific end usage demands in swimming pools. Further, we also ensure that these qualitative ranges of Drain Traps are made available in different finish specifications. These drain taps are used in inline agitation system & can handle both liquid and solid materials to pass through it.



## Suction Inlet

Suction Inlet is the point located on the pool wall which use for the vacuuming of the bottom dust



## Floor Inlets & Eye Ball Wall Inlet

Pool inlets are the points located in the pool through which filtered water returns back into the pool after passing

## Circular Drain

Manufactured using superior grade ABS material, round drain cover is available for both pre-fabricated and concrete pools. These drain covers can also be Customized as per the specific pool requirement.

### Special Features

- Made of white ABS with UV protection Included
- Side connection with 2" thread
- Available for concrete and pre-fabricated pools.
- Drain grilles used in concrete pools with a built-in main drain



## Skimmers

### 1. Standard Skimmer



### 2. Wide Mouth Skimmer





# Jacuzzi Fittings

## Air Water Tee Body Jet

Massage Jets for Jacuzzi in concrete & acrylic adjustable water & air flow quantity directional flow adjustment for lower & upper back & legs suitable for use with blowers.

Water Connection : 40 mm

Air Connection : 25 mm



## Air Controller

Air Volume Controller for Mixing Air in Massage Jet. Adjustable Air Volume & Muffler for Air Noise Reduction Made from ABS with 32 mm OD male Threaded Connection.

Air Controller 40 mm



## Air Bubbler Nozzle

Air Inlet Nozzles in Jacuzzi or Spa with 25 mm. Solvent & Threaded End Connection. Made from ABS. Suitable for Use with Blower.



## Spa Suction Drain

Spa Suction Drain made with ABS. Connection size 50mm dia.



## Air Blower

Side channel blower for air massage in spa pools and swimming pools. The side channel blower can be started from the poolside using pneumatic or low-voltage controls. The blower can be installed horizontally or vertically. Pipe connections are made via an air loop 50 cm above the water surface. Blower housing, blower wheel and side channel in cast aluminum.



## Pool Side Equipment

### Swimming pool Ladders

Swimming pool Ladders

Available in 2 steps, 3 steps, 4 steps, 5 steps



Loop Type



Overflow Type

### Overflow Gratings

Available size in 180 mm, 200 mm, 250 mm, 300 mm, 350 mm, 450 mm



## Pool Side Equipment

### Chlorination (Chlorine Feeder and TCCA 90 %)



TCCA 90% Granular and Table Form



9 LB (4 Kg) Online Chlorine feeder kit



# Auto dosing { pH! ORP } system

Auto dosing pump is proportional dosing pump with level control. It is driven by internal built-in pH or Redox (ORP) meter (electrode not included with standard scope of supply).

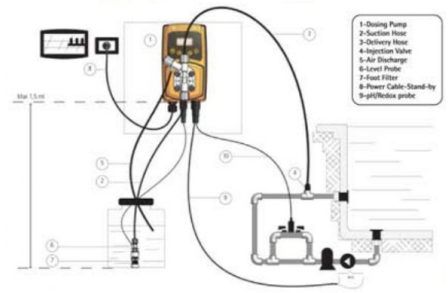

## Ranges:

pH: 0-14 pH

ORP: -999mV - +999mV

## FEATURES

Select pH or ORP parameter by menu: choose MODE and set pH or ORP.

In both modes, the pump can be set to dose in on / off or proportional.

In On / Off mode, the pump operates in two values (set-point)

In proportional mode the pump doses proportionally into the set point.

## Fast calibration

You can perform a fast calibration on standard value.

7.0 and 4.0 for pH, 650 mV for ORP. For different value proceed to a full calibration.

## Restore last calibration

If an error occurs during calibration you can restore last calibration saved.

## Alarms

Dosing, reading (probe failure), level and stand-by.

Alarm output status: N.O. or N.C.

## DELAY

Programmable delay at dosing start up.

## RESTORE FACTORY

Restore factory value (default value).

## PASSWORD AND LANGUAGE

Settable password and language (EN or FR).

## STAND-BY

Stand-by INPUT. (default N.O.:

VERIFY CHEMICAL COMPATIBILITY OF PUMP HEAD, O-RING AND HOSES BEFORE USE. Refer to & Chemical Compatibility table.



VMS series



WD series



AMS series



KMS series



TMS series



# Swimming Pool Accessories Manufacturer



**Vacuum Head**

Range : 14 inch and 18 inch  
Aluminum Vacuum Head



**Vacuum Hose Pipe**

Range : 9 meter, 15 meter and 30 meter



**Telescope Handle**

Range : 2.4 - 4.8 meter,  
4.5 - 9.0 meter



**Algae Brush**

Range : 10 inch and 18 inch  
stainless steel



**Wall Brush**

Range : 18 inch Nylon type wall brush



**Deep Rake Net**



**Leaf Skimmer Net (Shallow)**



**Chlorine &  
pH Measurement Test Kit**



**Trolley Mounted  
Suction Sweeper**



# Swimming Pool Lights

## Halogen type

Available in 100 Watt



## LED type

Available Range : 6 Watt, 9 Watt, 12 Watt, 18 Watt, 36 Watt

Color : Warm White, Blue, White, Green, Red



## SS LED Type

Available Range : 10Watt, 20Watt

Color : RGB



Email Id : [aasthawatercare@gmail.com](mailto:aasthawatercare@gmail.com), Call : +91-7990866062, +91-7990866062

# Swimming Pool Pumps

1. Swimming Pool
2. Chlorinator
3. Pump
4. Sand Filter
5. Pool Chiller & Heat Pump

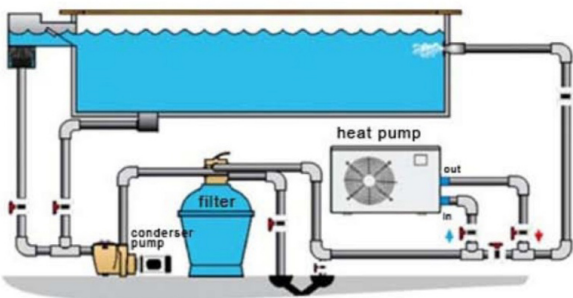
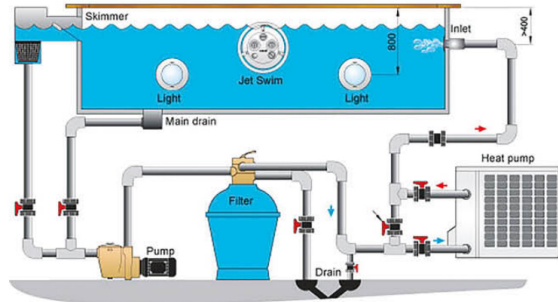

## 1. Heat Pump



## Special Products

### Robotic Pool Cleaner

1. Cleans all surface types
2. Climbs walls and obstacles
3. Scrubs waterline
4. PVA brushes for superior grip
5. No installation required
6. Minimal maintenance
7. Clean filter bad indicator  
(115V model only)
8. Convenient caddy option available



### Counter Current System



### Endless Pool



## *Life Saving Equipments*



Life Ring



Life Jacket



Life Guard Chair

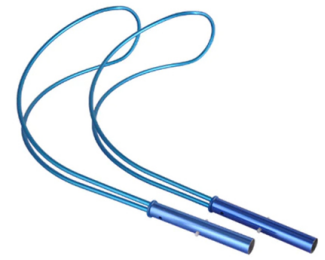

Life Saving Hook  
Manufacturer



Floating Bed

## *Life Saving Equipments*



Starting Blocks



Lane Ropes & Reel



False Start  
Indicator Post



Back Stroke  
Indicator Post



Diving Board with Fulcrum





## Readymade Jacuzzi



## Swimming Pool Covers and Roller

We offers a range of swimming pool covers to suit every need, from our exclusive premium quality, premium payback cover, through to the new and unique Geo-Bubble design which has multiple user benefits, right to the long established industry 400 and 500 micron traditional bubble covers with roller.

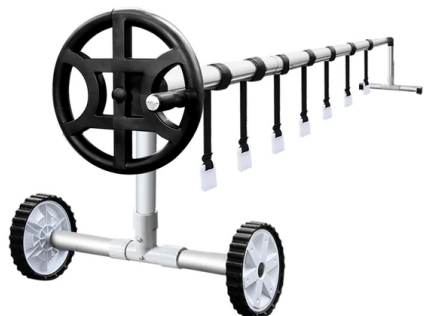

# Water Curtain

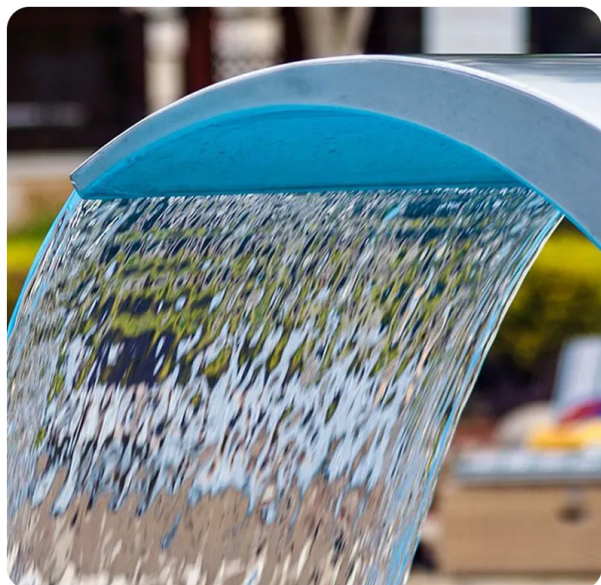

Waterfall Curtain uses the power of night speed water pillar, to knead the head, neck, shoulder and back. Its can wake the pain, reduce the gead pain, remove the tire, relax the muscles and remove the pain from the shoulder.

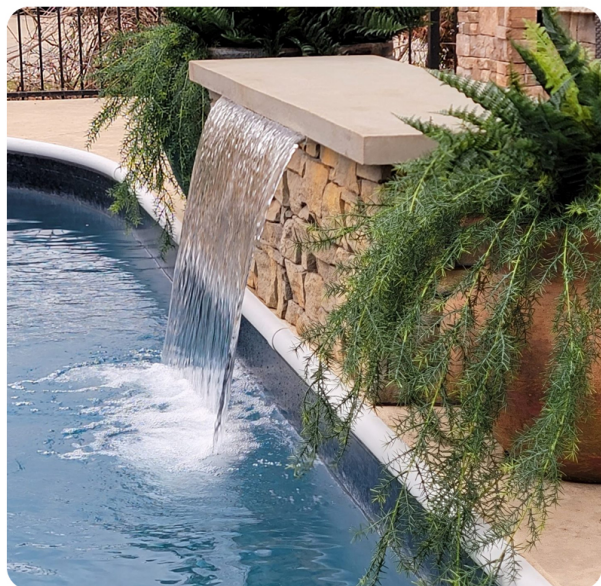
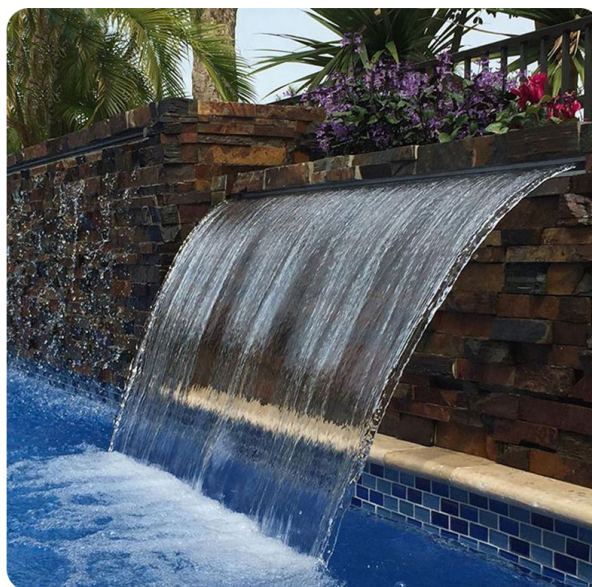

Technical Details	
ASWF300	Acrylic Waterfall 300mm with LED light
ASWF600	Acrylic Waterfall 600mm with LED light
ASWF900	Acrylic Waterfall 900mm with LED light
ASWF1200	Acrylic Waterfall 1200mm with LED light



# SPA Fittings



## Jaquzzi Nozzle

- ◆ These high performance spa jets shall allow clients to have complete control of pressure & direction. Jets turn on/off by rotating the nozzle or jet face. Jets can be easily removed from inside the tub for servicing or cleaning.
- ◆ Flow 4.5 cu mtr/hr @ 0.8 BAR
- ◆ Connection size of 50 x 50 mm available

Code	Description
RWSP	Spa nozzles with a flow rate of 4.5 cu.mtr. water connection 50mm & air connection 50mm



## Air Bubbler Nozzle

- ◆ Bubbler nozzle allows air into pool with air pipe network
- ◆ Comes with tube/ solvent/ threaded connections so that it is easy to connect with pipe network
- ◆ Top portion is adjustable enabling quantity of air movement into pool

Code	Description
REAN	Air Bubbler nozzle with 20 mm Connection



## Air Controller

- ◆ Air controller capable of allowing air into the pipe network with the venturi arrangement available in jacuzzi nozzles. Comes with solvent / threaded connections so that it is easy to connect with pipe work
- ◆ Top portion is adjustable enabling quantity of air movement into pipe network

Code	Description
RAVC	Air volume controller to regulate the air flow in the nozzle



## Bush Button

- ◆ These air buttons push air to your controller to operate the blower.
- ◆ Air buttons are located at spa-side & are used to control the air switches which are connected to your spa equipment.
- ◆ It comes with solvent connection.
- ◆ 3-4 mm Air tube connection

Code	Description
RPB	Push button ABS with 1" threaded connections



## Pneumatic Switch

- ◆ Single function control switches provide safe actuation of electrical devices from remote locations
- ◆ Connected with 3-4 air tube on one side & other side Connected with pump control panel

Code	Description
RNS	Pneumatic switch for pump control panel to connect the push button.



## Air Tube

- ◆ Manufacture in PVC
- ◆ Coil of Air tube length is 20 mtr Only

Code	Description
RWAT	Air Tube Per Mtr. (Only Sold in Multiples of 25 mtr)

# Counterflow System

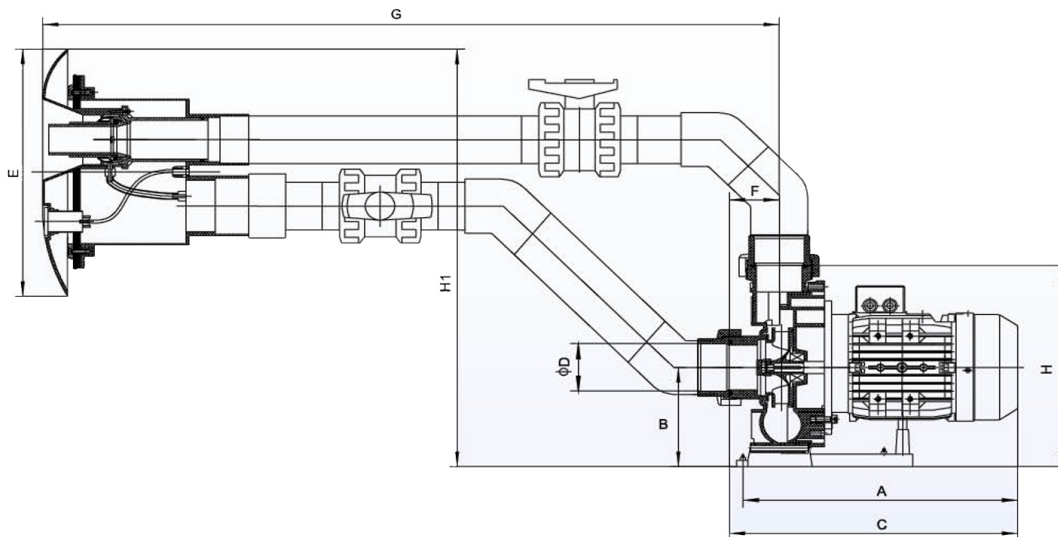
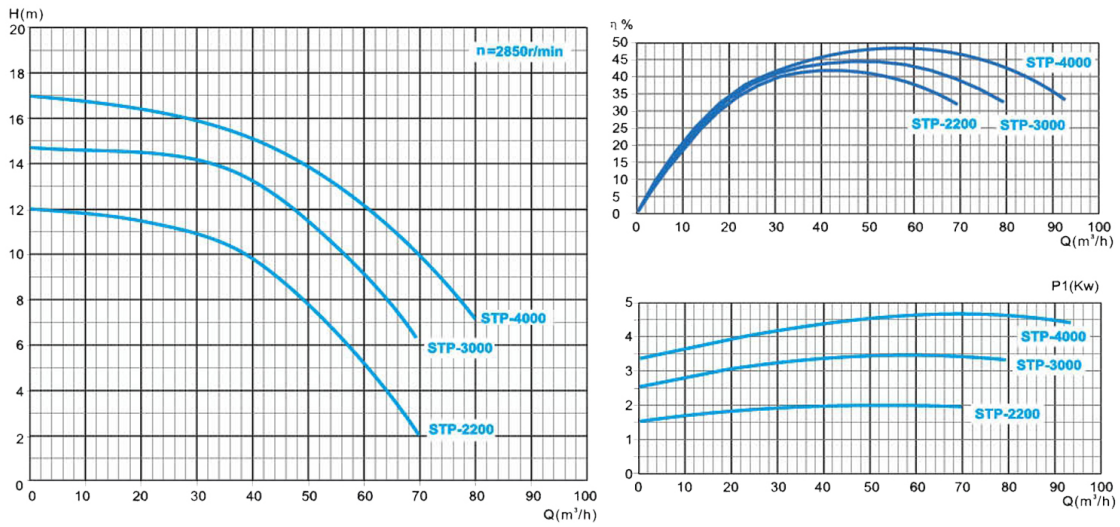

## Dimension (MM)

Model	A	B	C	D	E	F	G	H	H1
STP-2200S	370	156	440	Ø 75	395	77	1110	340	635
STP-3000S	410	156	470	Ø 75	395	77	1110	340	635
STP-4000S	440	156	500	Ø 75	395	77	1110	340	635



# AASTHA WATER CARE

POOL PRODUCTS & SERVICES



## Aastha Water Care

**Contact No :** +91-7990866062, +91-7990866062

**Email id :** [aasthawatercare@gmail.com](mailto:aasthawatercare@gmail.com)

**Address :** Shree Saikrupa Complex, Shop-3, Mahmoodpura  
Gam, B/h. Karnavati Slub, S.G. Road, Ahmedabad-380051

THANKS FOR  
**SCROLLING**

*Thank You*